

BioEntry P2

Compact IP Fingerprint Device



Suprema BioEntry P2 is a compact fingerprint access control device featuring Suprema's next generation biometric technology and security platform. BioEntry P2 provides class-leading performance and security by featuring Suprema's latest fingerprint algorithm coupled with powerful 1.0GHz CPU. Packed in a million-type sleek design, BioEntry P2 also provides added flexibility in system design by featuring multi card reading with dual-frequency RFID technology. With its selection of communication interfaces and credential options, BioEntry P2 is a perfect IP access control solution for sites large or small.

Features



Best-in-class Performance

- Latest Suprema algorithm
- Fast matching: Max 10,000 match/sec
- Powerful 1.0GHz CPU
- High-precision OP6 optical sensor



Enterprise-level Capacity

- Max. 10,000 users
- Max. 1,000,000 event logs



Multi RFID Card Reading

- LF(125kHz), HF(13.56MHz) dual-band
- Reads all card types including HID multiCLASS (EM/HID Prox/MIFARE/iCLASS/DESFire/FeliCa/NFC)



Versatile Interfaces

- Communication: TCP/IP, RS-485, Wiegand
- Input/output: TTL I/O, Relay

Specifications

Model Name	BEP2-OD	BEP2-OA
RF Option	125kHz EM & 13.56MHz MIFARE, MIFARE Plus, DESFire/EV1, FeliCa, NFC	125kHz EM, HID Prox & 13.56MHz MIFARE, MIFARE Plus, DESFire/EV1, FeliCa, iCLASS SE/SR/Seos, NFC
Biometric	Fingerprint	
Sensor Type	Optical Sensor (OP6)	
Template	SUPREMA / ISO 19794-2 / ANSI 378	
Extractor / Matcher	MINEX certified and compliant	
CPU	1.0 GHz	
Memory	8GB Flash + 64 MB RAM	
Max. User (1:1)	10,000 (Based on one finger enrollment per user)	
Max. User (1:N)	10,000 (Based on one finger enrollment per user)	
Max. Finger per user	10	
Max. Text Logs	1,000,000(text)	
LED	Multi-Color	
Sound	Multi-tone Buzzer	
Ethernet	10/100 Mbps, auto MDI/MDI-X	
RS-485	1ch Host or Slave (Selectable)	
Wiegand	1ch Input or Output (Selectable)	
TTL	2ch Input	
Relay	1 Relay	
Tamper	Supported	
Power	DC 12V	
Dimensions (WxHxD,mm)	50 x 164 x 37.5	
Certificates	CE, FCC, KC, RoHS, REACH, WEEE	

System Configurations

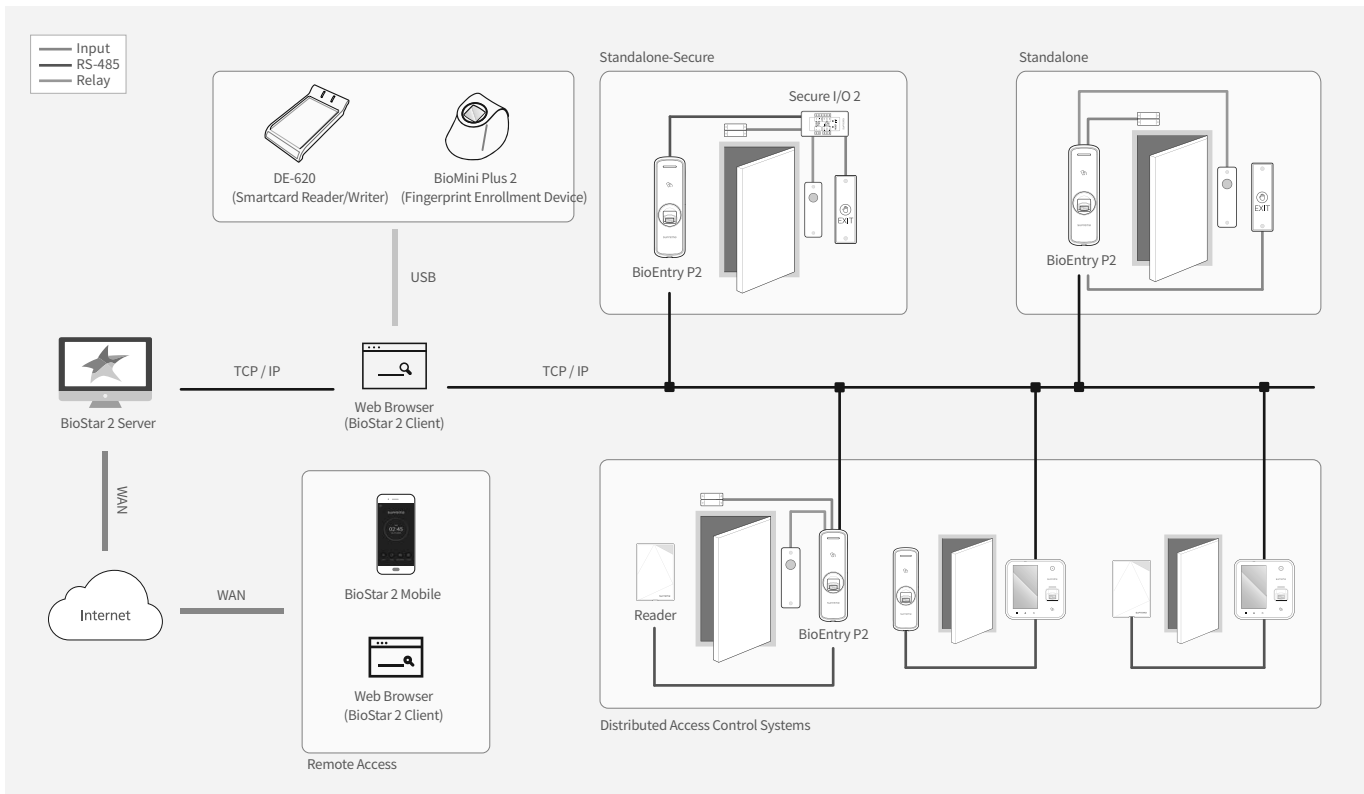

Suprema Inc.

17F Parkview Tower, 248, Jeongjail-ro, Bundang- gu, Seongnam-si, Gyeonggi-do, 13554, Rep. of KOREA
 T +82 31 783 4502 F +82 31 783 4503 E sales_sys@supremainc.com www.supremainc.com

©2019 Suprema Inc. Suprema and identifying product names and numbers herein are registered trade marks of Suprema, Inc. All non-Suprema brands and product names are trademarks or registered trademarks of their respective companies. Product appearance, build status and/or specifications are subject to change without notice. [SUPREMA-AHL-BEP2-EN-REV08]



ASSISTA INFOCOMM & SECURITY PTE LTD

Office: 61 Kaki Bukit Avenue 1, # 05-40 Shun Li Industrial Park, Singapore 417943.

Tel: (65) 6744 3178 Fax: (65) 6729 6748

Showroom: 11 Woodlands Close #09-23 Woodlands 11 Singapore 737853.

Tel: (65) 6337 2148 (Hotline Available 9am - 9pm Singapore Time, 7 days a week)

Assista InfoComm & Security Pte Ltd places value creation at the core. Assista assists organizations and individuals to improve daily operations and enhance living through the applications and promotions of InfoComm & Security Technologies. The activities include international & domestic sales, marketing, development, installation, service, maintenance, consultation & training of InfoComm equipment, software & technologies related to the Infrastructure, Network & Physical Access Security.

Assista is better known as

- GPS/ CDMA Time & Frequency Solution Specialist
- CCTV Remote Viewing System Specialist
- High Definition Surveillance System Specialist
- Multi-Networked Advanced Door Access Control System Specialist
- Wired & Wireless Alarm Systems Installer
- IP-PBX & Key Telephone System Installer
- Professional Cabling Contractor for CCTV, Telephone & Computer Network Systems
- Security, IT & Telecommunications Systems Integrator
- Product Developer
- Importer & Exporter

**Alternatively, you may e-mail your enquiries to
info@assista.com.sg**